

## Tube Mount Cable Railing Installation Advice

This deck balustrade cable system is designed to fit neatly onto 1 11/16 inch (42.4 mm) diameter tubular posts.

### Each cable railing kit consists of :

- 5/32 inch Ø 7x7 stainless steel cable to your chosen length.
- Two scalloped stainless steel mounting sockets.
- One compression ball.
- One adjustable tensioner with lock nut.
- Two stainless steel M6 screws.

Manufactured from 316 (marine) grade stainless steel, making this kit ideal for harsh outdoor conditions.

### Preparation :

Before installation we would recommend you consult with your local building control.

Plan your project in advance to ensure you have the correct number of posts, cables and fittings remembering to take into consideration end post and corner post termination clearance and position.



Stainless steel wire cables should be spaced a maximum of 3 inches apart.

Vertical posts should be spaced at recommended 5 ft intervals (up to a maximum of 6 ft 5 in apart) to ensure a strong frame.

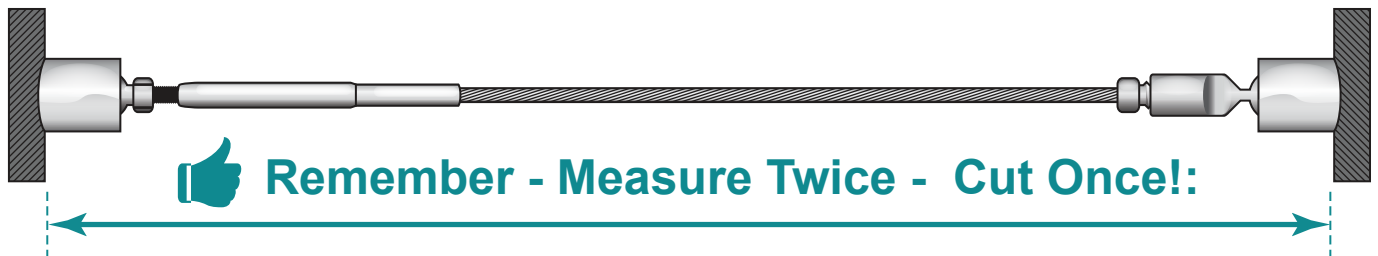

### 1 Getting Started

It is a good idea to layout your design onto the relevant surface with a pen or chalk prior to drilling any holes.



### 2 Drill & Tap Holes

You will need to drill and tap M6 holes into the posts to accept the socket and screw. ('tap' refers to the method of drilling a hole whilst adding an internal thread. A special drill bit is required to achieve this.)

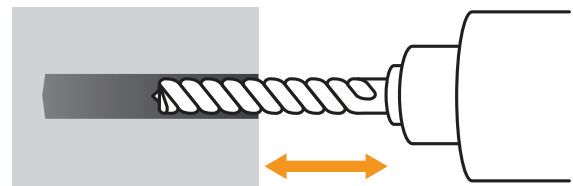

### 3 Mount Hubs into Position

Thread a M6 screw through the centre hole of your socket and align to the post, with the socket opening pointing downwards (for a neat and tidy finish).

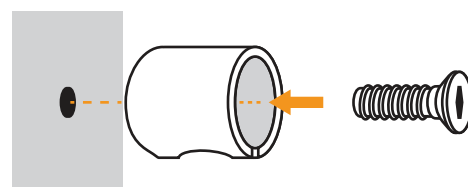

## Tube Mount Cable Railing Installation Advice

### 4 Fix Socket

Using a hex head key, tighten the M6 screw until your socket is securely fastened to the post.

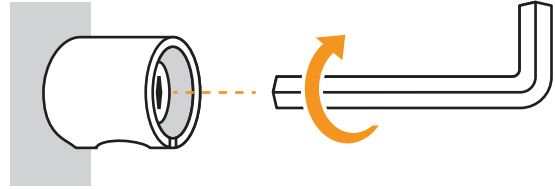

### 5 Prepare Pre-Fixed Ball End

Starting with the pre-fixed tension ball end, screw out the ball end to reveal approximately 0.7 inch of thread, you will need this to apply your final wire tension once installed.

Each cable has an adjustment of +/- 0.7 inch.

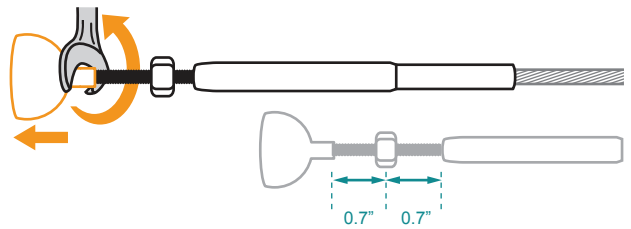

### 6 Mount The Pre-fixed Ball End

Place the pre-fixed tension ball end into the mounting hub.

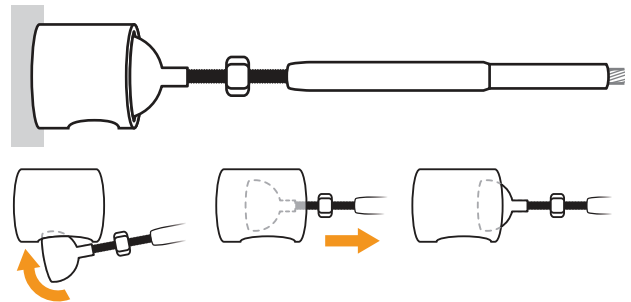

### 7 Mark Cable for Cutting

Place the DIY ball compression fitting into the opposite mounting hub and pull the cable over and align to the spanner flat of the DIY compression fitting.

Mark your wire ready for cutting with either a pen or chalk.

Note:

The stand off from the mounting hub is 1.18 inch (30mm).

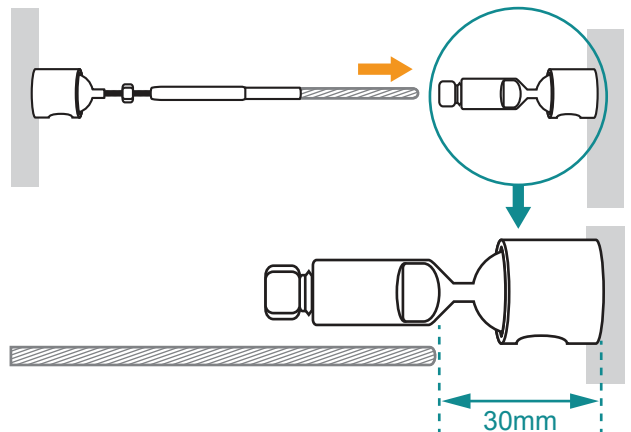

### 8 Cut Cable

Cut your cable to required length, we recommend using a set of good cable cutters to give you a neat and tidy cut.

**Remember - Measure Twice, Cut Once!**  
**Please be as accurate as possible.**

Each cable will have an adjustment of + /- 0.7 inch.

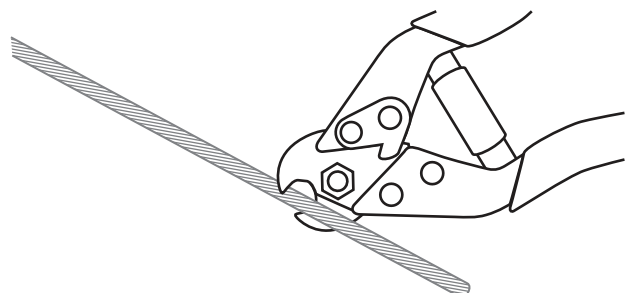

## Tube Mount Cable Railing Installation Advice

### 9 DIY Compression Fitting

You are now ready to attach the DIY end fitting.

The first step is to take apart your DIY compression fitting.

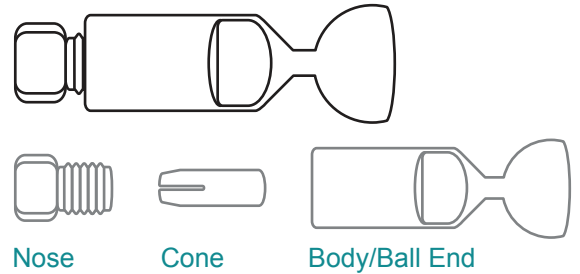

### 10 Thread Nose Piece onto cable

Taking the blank cable end place the nose piece over the stainless steel wire rope (ensuring the thread end is towards the end of your cable).



### 11 Place Ball End onto Cable

Take the stainless steel body and push onto the cable, eventually bringing the three component parts together. Turn in opposite directions to thread them together.

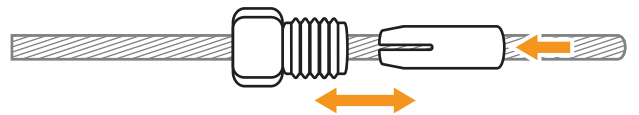

### 12 Thread Cone onto Cable

Thread the cone onto the cable and push into the threaded cone chamber.

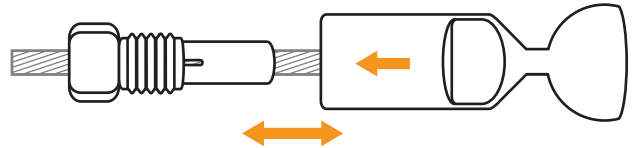

### 13 Secure Ball End Fitting

Using a pair of 8mm and 9mm (metric) wrenches screw the two sections together until tight.

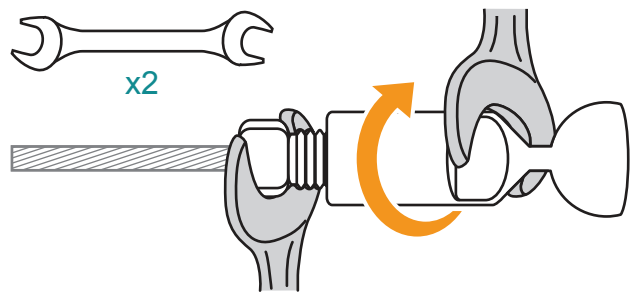
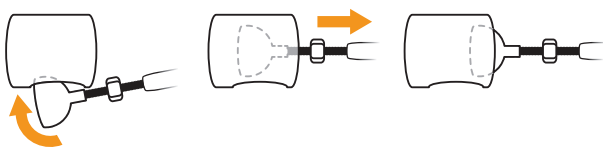

### 14 Mounting Ball End Fitting

Insert the DIY ball end into the fixing hole of the hub.

Note: if you require more slack in your cable to insert the DIY end simply return to the fixed end ball and unscrew to expand to the required length.

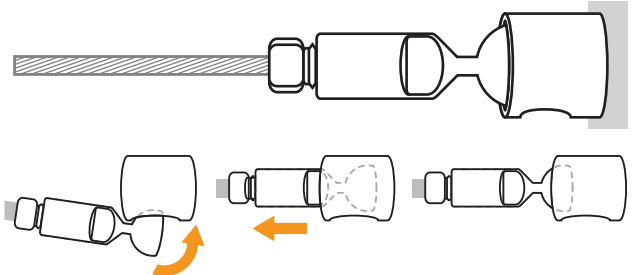

## Tube Mount Cable Railing Installation Advice

### 15 Tension Cable

Returning to the pre-fixed ball end, simply screw the threaded ball end fitting in to achieve the desired cable tension.

Once you have tensioned the cable simply tighten the lock nut into place using a wrench.

Important - do not allow the cable to be twisted.

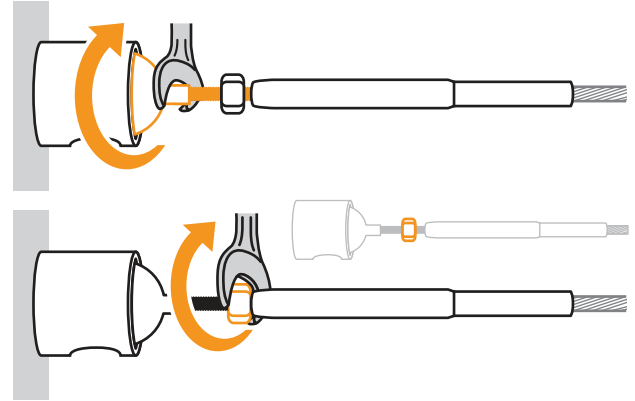

### Tensioning Sequence

To tension the balustrade cables, we recommend starting from the centre and working out.

Do not fully tighten individual cables as this will create uneven tension throughout your system, just tighten enough to hold in place.

Once all your wires are installed, tighten each cable in turn by slight increments to achieve a solid and fully secure finish.



### Product Dimensions - Supplied in metric millimeters

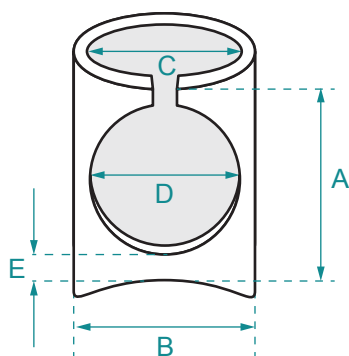

- A 22.5 mm
- B 21.7 mm
- C 14 mm
- D 15.5 mm
- E 5 mm

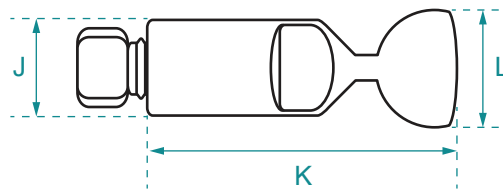

- J 12 mm
- K 35.2 mm
- L 15.8 mm

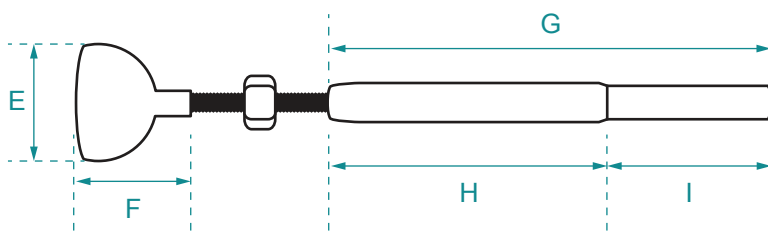

- E 15.8 mm
- F 17 mm
- G 95 mm
- H 55 mm
- I 40 mm